

# THE FORESTS OF CHRISTIANSTED VALLEY

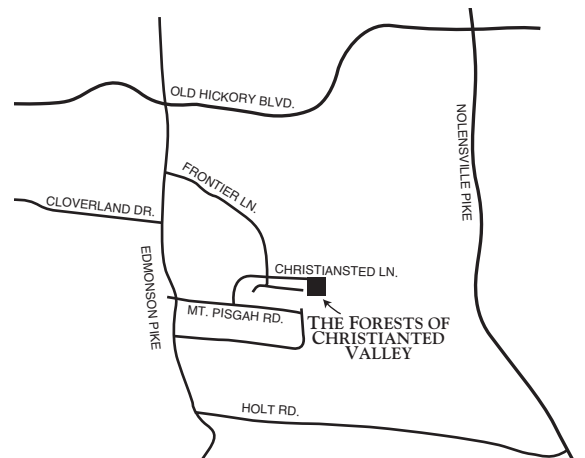
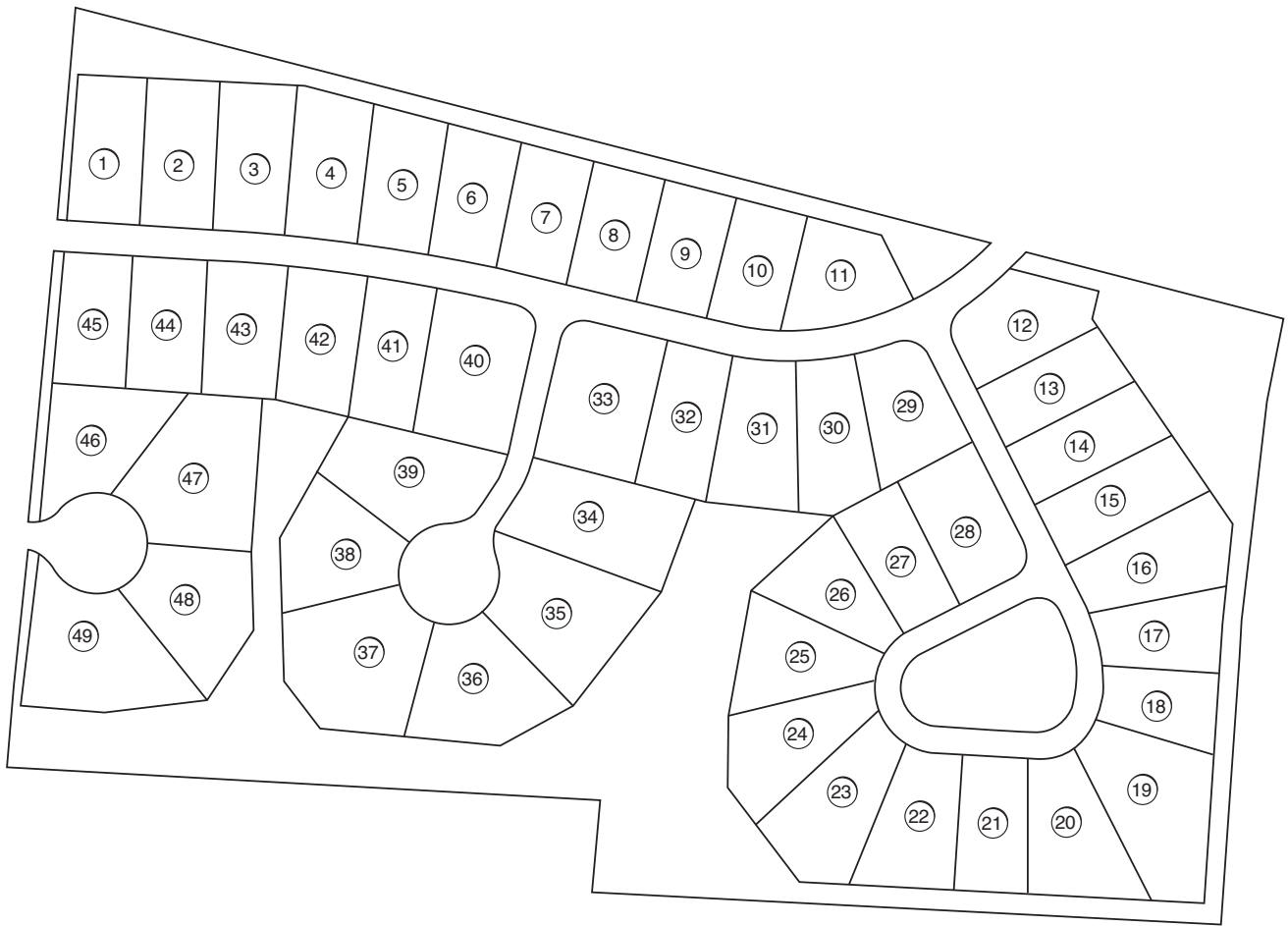

*distinctive quality built homes*

# THE FORESTS OF CHRISTIANSTED VALLEY

## LIFESTYLE AMENITIES

The Forests of Christiansted Valley is a quality, family community conveniently located just minutes from shopping, schools, interstate, and downtown Nashville. The community's charm comes from the care and preservation of its natural forest surroundings. Turnberry Homes is proud to be selected as builder of classic, handcrafted design homes in this premier neighborhood.

## CONVENIENT LOCATION

The Forests of Christiansted Valley is ideally situated off Mt. Pisgah Road and Edmondson Pike in the heart of the south Davidson County countryside and only minutes to shopping, schools and interstate. Convenience of universities, recreation and downtown are also only minutes away.

## SHOPPING

The convenience of shopping Krogers and other area retailers located only minutes away. The Cool Springs Galleria, located minutes away via Interstate 65 South is the area's newest and largest shopping complex featuring over 100 shops.

## RECREATION

Crocket Park, YMCA and Maryland Farms are all facilities within minutes from Winfield Park. The Legends Club, just minutes from The Forests of Christiansted Valley offers a 36 hole resort golf club. Other golf course located nearby are Harpeth Hills and Governor's Club.

## SCHOOLS

### **Granberry Elementary**

Grades K-4  
615-333-5112

### **William Henry Oliver Middle School**

Grades 5-8  
615-332-3011

### **Overton High School**

615-333-5135

## UNIVERSITIES

Over 16 colleges and universities are an easy commute from The Forests of Christiansted Valley, including Vanderbilt University, Belmont University, Tennessee State University, Lipscomb University, Columbia State Community College, Fisk University and the O'More College of Design.

This information is deemed reliable but not warranted as of 5/5/2006.

